

Machine Data Sheet

Machine: 3001/3001DRO	VMC Vario Milling Machine
<u>Product Dimensions:</u>	
Weight	415KG
width x Depth x Height	1075 X 940 X 1730mm
Stand only Width x Depth x Height	705 x 565 x 520mm
Base Width x Depth	400 x 560mm
<u>Shipping Dimensions</u>	
Length x Width x Height	970 x 820 x 1800mm
<u>Power/Motor</u>	
Motor size	1.5kw
Power Transfer (GH) gearbox or (VS) variable speed	VS
Voltage (240v single) (440v 3 Phase)	240V
Fitment (Plug connection type)	3 Pin Plug
Current	50hz 7.2A
Spindle speeds (No: and achievable speeds)	2 Speed, L =100-600 H =425-2500
<u>Main Specifications</u>	
Table size	740 x 160 mm
Longitudinal travel (X)	360mm
Cross Table travel (Y)	135mm
Head Travel or Knee (Z)	310mm
Quill/Spindle stroke	85mm
Distance spindle to table	328mm
Throat (Spindle middle to Column)	168mm
Table height from base	440mm
Spindle Taper size and thread	R8 7/16 unf
Head tilt left to right and Head tilt front to back	90-90 (45-45 calibrated) & 45-45 ROTATION
Drilling capacity	16mm
Milling capacity	20mm
Spindle Bearing type	Taper Roller
<u>Other Specifications</u>	
Country of origin	China
Warranty	12 Months
Approximated assembly and setup time	30 mins
CE approved Certificate	Yes, available upon request

Machine Data Sheet

<u>Additional products</u>	
Optional stand	Included
Optional power feed	3205A
Optional Digital Read Out Kit	8123 DRO
X axis scale (left to right)	400mm
Y axis scale (forward to back)	200mm
Z axis scale (head)	400mm
Tee Nut size and no of slots	3 Slots, 8013 Clamp set 12mm
Machine/Stand Hole positions	A=530 B=375 C=100 D=90mm

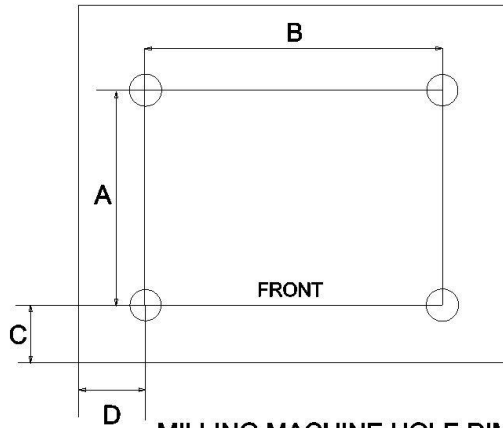

MILLING MACHINE HOLE DIMENSIONS