

Machine Data Sheet

Machine: 3034YZ/DRO	Super Major Milling Machine
<u>Product Dimensions:</u>	
Weight	420KG
width x Depth x Height	1270 X 930 X 2134mm
Stand only Width x Depth x Height	570 x 780 x 622mm
Base Width x Depth	400 x 600mm
<u>Shipping Dimensions</u>	
Length x Width x Height	900x 880 x 2100mm
<u>Power/Motor</u>	
Motor size	1.5kw
Power Transfer (GH) gearbox or (VS) variable speed	VS
Voltage (240v single) (440v 3 Phase)	240V
Fitment (Plug connection type)	3 Pin Plug
Current	50hz 7.2A
Spindle speeds (No: and achievable speeds)	6 Speed, 75, 180, 280, 600, 1000, 1600
<u>Main Specifications</u>	
Table size	800 x 240mm
Longitudinal travel (X)	445mm
Cross Table travel (Y)	195mm
Head Travel or Knee (Z)	415mm
Quill/Spindle stroke	125mm
Distance spindle to table	450mm
Throat (Spindle middle to Column)	215mm
Table height from base	260mm
Spindle Taper size and thread	R8 7/16 unf
Head tilt left to right and Head tilt front to back	90-90 (45-45 calibrated)
Drilling capacity	16mm
Milling capacity	20mm
Spindle Bearing type	Taper Roller
<u>Other Specifications</u>	
Country of origin	China
Warranty	12 Months
Approximated assembly and setup time	30 mins
CE approved Certificate	Yes, available upon request

Machine Data Sheet

<u>Additional products</u>	
Optional stand	Included
Optional power feed	X axis included
Optional Digital Read Out Kit	8123 dro
X axis scale (left to right)	450mm
Y axis scale (forward to back)	200mm
Z axis scale (head)	450mm
Tee Nut size and no of slots	3 Slots, 8013 Clamp set 12mm
Machine/Stand Hole positions	A=465 B=325 C=130 D=125mm

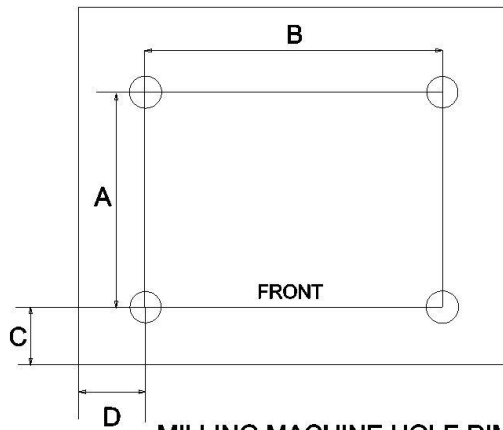

MILLING MACHINE HOLE DIMENSIONS